

Shoppes of 54 - Retail

7643 State Road 54, New Port Richey, FL 34653



Features

- 11,723 sf retail center anchored by Central Park Restaurant
- Adjacent to new Dunkin Donuts, Wendy's and 30,000 sf Medical Office Park.
- Located 1/4 Mile East of Seven Springs Blvd directly on State Road 54 in the Trinity area of Pasco County.
- Parking Ratio of 6.6/1,000
- Traffic Count of 35,500 ADT for State Road 54 just West of Little Road.

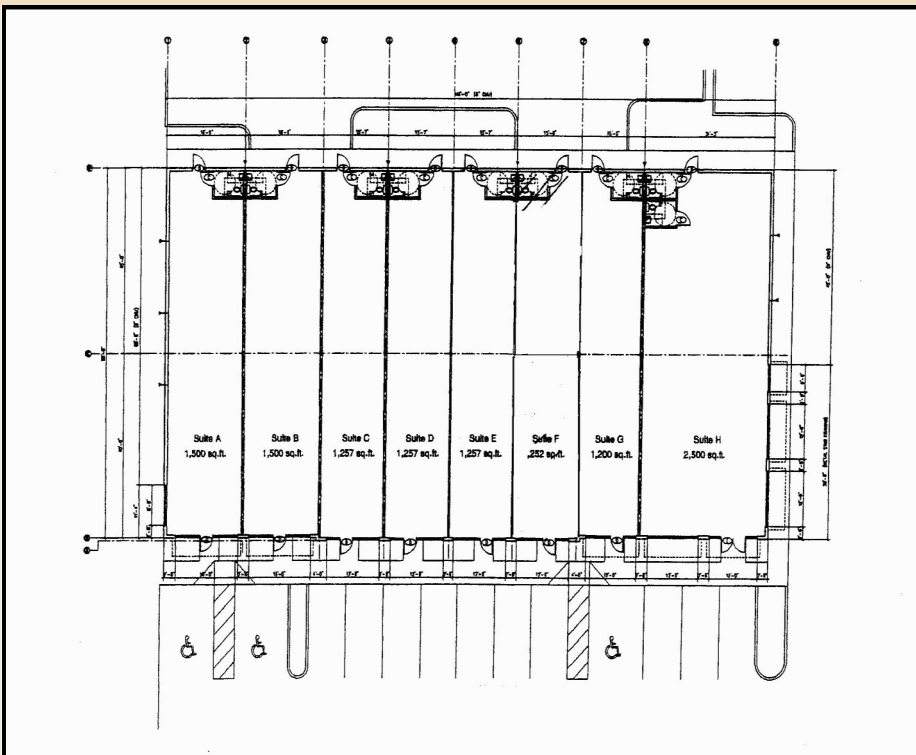

Demographics			
2008	1-Mile	3-Mile	5-Mile
Population	10,726	70,679	145,428
Average Income	\$53,576	\$54,975	\$57,622

Contact Information

Dan Lee (727) 479-3675
 David Scher (727) 460-2185
 Office (727) 796-1077

REF #	Square Footage
A	1,500
B	1,500
C	1,257
D	1,257
E	1,257
F	1,252
G	1,200
H	2,500

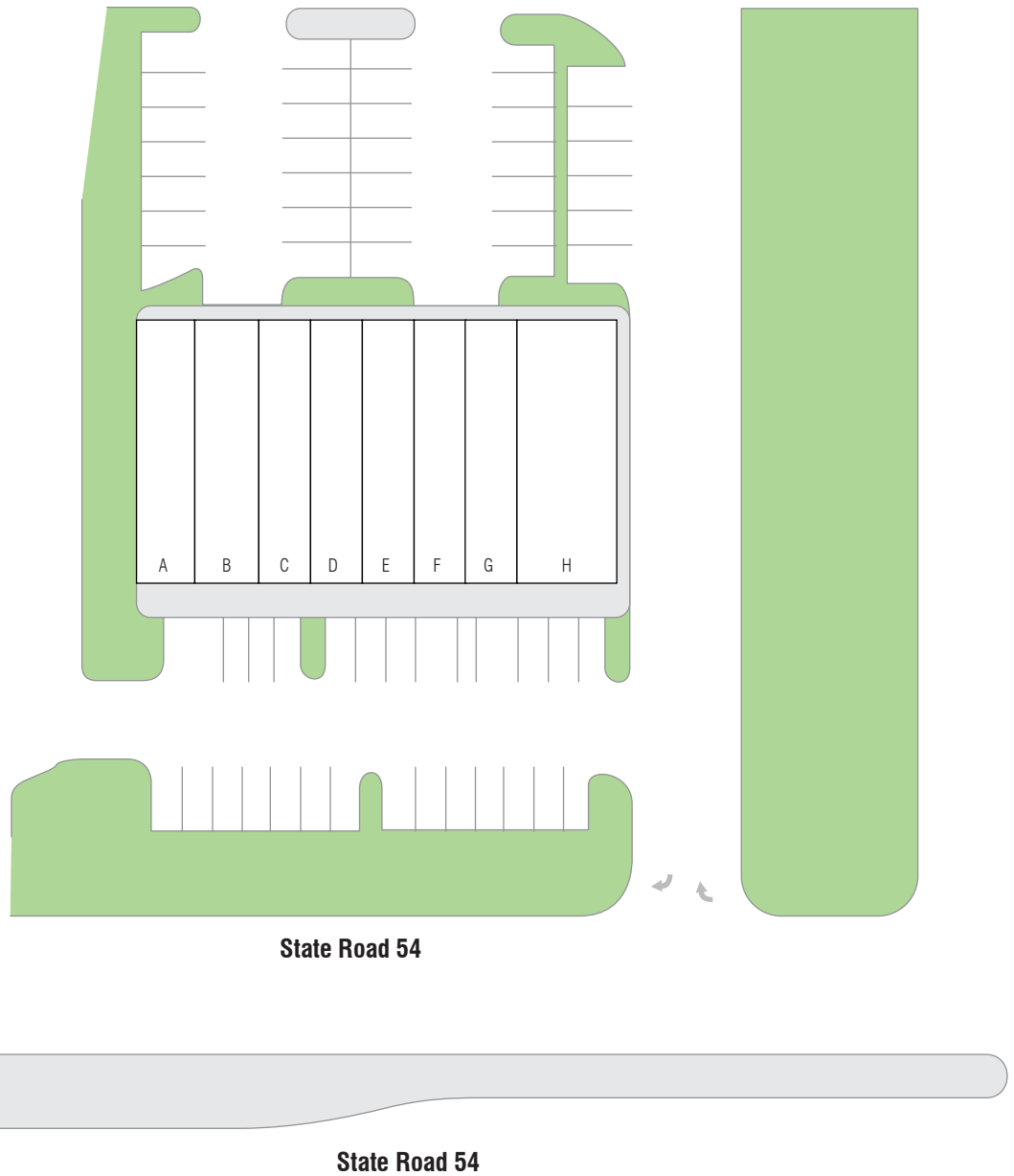

Included

